

Blok Desk in Hot Rolled Steel

With a minimal aesthetic, the elegant lines and angles of the **Blok** range of reception desks are specified for office and reception spaces of all sizes, from a selection of modular components which are installed as one highly finished piece. Available as part of the Isomi in Metal collection in lacquered hot rolled steel, copper and brass, the desks are perfectly suited to contemporary public spaces and reception environments.

Key features

Easy to specify modular components

Three height options of 760mm, 950mm and 1100mm as standard

CAD and BIM files available

Illuminated branding, sign-in platform and storage units available as options

Reception desks can be handed to the left or right

DDA modules available

Inset black matt laminate worktop, LED light trough and cable management included as standard

Made in authentic, hand-selected hot rolled steel.

Available in 6–8 weeks (UK), 12-14 weeks (US)



Blok Desk in Hot Rolled Steel Modules

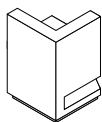

BD01
Left End
W800
D875
H760/950/1100 mm

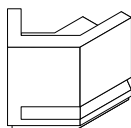

BD02
Left End Angle 45°
W875
D875
H760/950/1100 mm

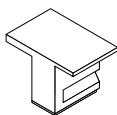

BD03
Left End DDA
W800
D1175
H760 mm

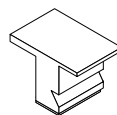

BD04
Straight DDA
W800
D1175
H760 mm

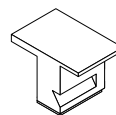

BD05
Right End DDA
W800
D1175
H760 mm

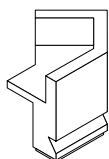

BD06
Right End Angle 45°
W875
D875
H760/950/1100 mm

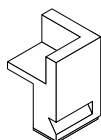

BD07
Right End
W800
D875
H760/950/1100 mm

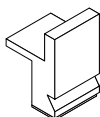

BD08
Straight
W800
D875
H760/950/1100 mm

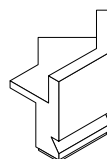

BD09
Angle 45°
W875
D875
H760/950/1100 mm

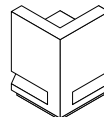

BD10
Angle 90°
W875
D875
H760/950/1100 mm

Accessories

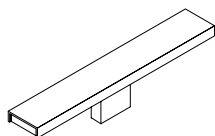

Blok
Sign-in platform/light
Powder coated aluminium
W1520
D250
H350 mm



TB
Translucent branding
W800
H200 mm
(recommended dimensions)



LS
LED skirting

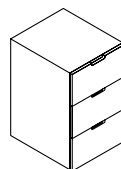

DU
Drawer unit
W400
D250/525
H700 mm

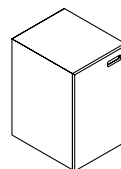

CU
Cupboard unit
W400
D250/525
H700 mm

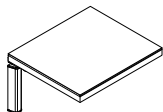

Electric sit-stand desk
H650-950
D600-3000 mm

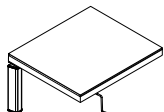

Manual sit-stand desk
H650-950
D600-3000 mm



Infrared heating panel



**Blok Desk in Hot Rolled Steel
Configurations**



Configuration 1

W1600
D875
H760/950/1100 mm



Configuration 2

W2400
D875/1175
H760/950/1100 mm



Configuration 3

W2400
D875
H760/950/1100 mm



Configuration 4

W3200
D875/1175
H760/950/1100 mm



Configuration 5

W4000
D875/1175
H760/950/1100 mm

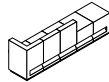

Configuration 6

W4800
D875/1175
H760/950/1100 mm

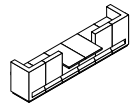

Configuration 7

W2730
D875/1175
H760/950/1100 mm



Configuration 8

W1595/1595
D875
H760/950/1100 mm



Configuration 9

W2400/1595
D875/1175
H760/950/1100 mm

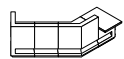

Illustrations above relate to the product at 950mm height.



Configuration 10

W2475/2475
D875
H760/950/1100 mm

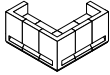

Configuration 11

W2475/2475
D875/1175
H760/950/1100 mm

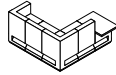

Blok Palette

Metal



Hot Rolled Steel
M001



Copper
M002



Copper
M003

Alternative colours are available on request. For a full list of colour options please download our colour chart. The printed representation of colours may vary from actual samples. Always request actual samples before ordering.
